



eBM  
for Windows



## APS ELECTRONIC BUILDING MANUAL



# Construction Design Management

Electronic  
Building  
Manual  
eBM

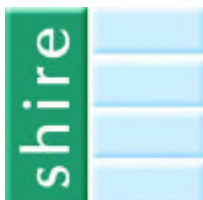

THE ASSOCIATION OF PLANNING SUPERVISORS



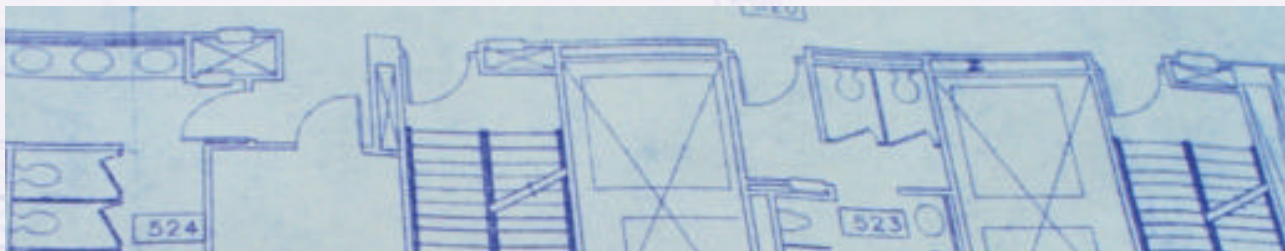

External drawings, charts, schematics and operators' manuals may be scanned and stored electronically to be referenced by the system. Even Hard Copy like samples, may be referenced by the system.

The eBM file is a very flexible system and is designed to handle data for multiple sites and projects and is ideal for designers, planning supervisors, facilities managers and all those who compile data on behalf of their clients

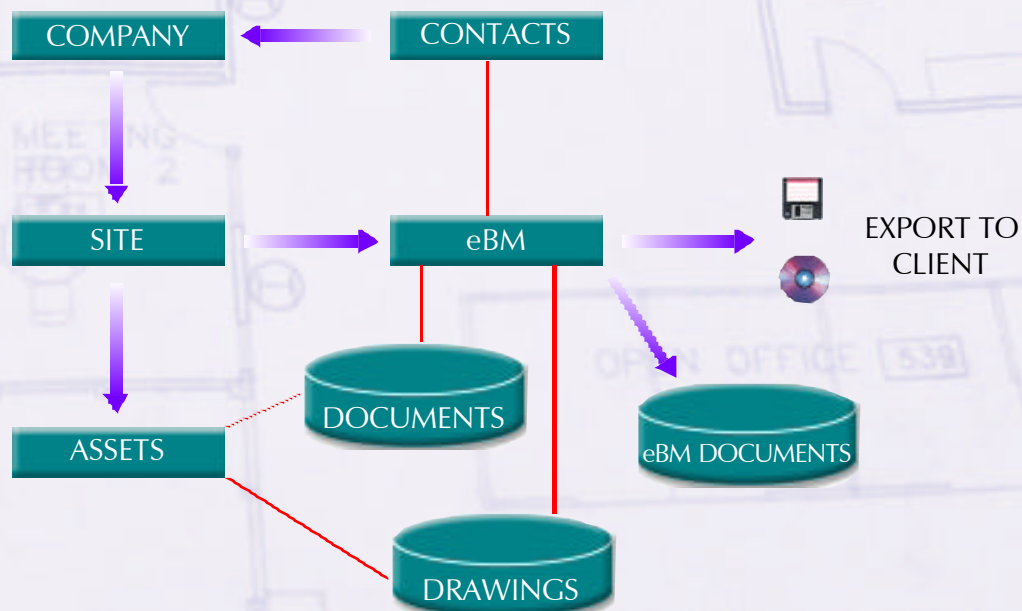



## SUMMARY

### eBM

- Stores and manages all relevant information for a CDM Health & Safety File
- Is very flexible and simple to tailor to your specific requirements
- Handles multiple sites and multiple projects
- Forms and Electronic Building Manual saving time, space and resources

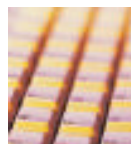

## System Requirements

The minimum requirement for running the system is a PC with 64MB RAM, a Pentium II 350 Mhz processor and a high speed disk running under Windows 95, 98 or NT workstations and local area network supporting Windows. It also requires a Windows supported printer. If image data is exported regularly, then a writable CD is recommended.

You will also need the following installed: Microsoft Word 7/97, SR2a and Internet Explorer 4 or 5.



**Shire Systems Limited**  
1 Mountbatten Business Centre  
16 Millbrook Road East  
Southampton SO15 1HY  
Phone: 023 8022 4111  
Fax: 023 8022 8475  
E-mail: [sales@shiresystems.co.uk](mailto:sales@shiresystems.co.uk)  
Web: [www.shiresystems.co.uk](http://www.shiresystems.co.uk)

**The Association of Planning Supervisors**  
16 Rutland Square  
Edinburgh EH1 2BE  
Phone: 0131 221 9959  
Fax: 0131 221 0061  
E-mail: [info@aps.org.uk](mailto:info@aps.org.uk)  
Web: [www.aps.org.uk](http://www.aps.org.uk)